

Bellows type

Type JOB40, 41 Bellows Expansion Joints

Construction

Single type

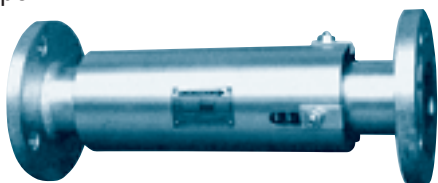

Single type

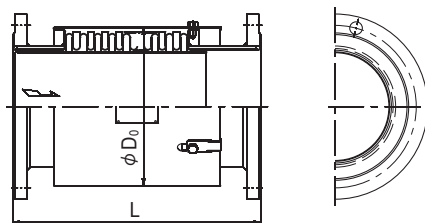

Double type



Double type

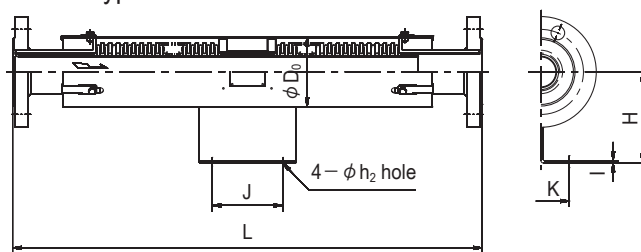

Features

- Bellows made of anti corrosive material SUS316L (low carbon stainless steel)
- Parts for fluid contact made of stainless steel
- No leakage because packing is not used.

Specifications

Size	20-300
Max. allowable pressure	2.0MPa
Hydrostatic pressure	3.0MPa
Max. allowable temperature	220°C
Fluid	Steam, water, oil and non-corrosive gas
Connection	Flanged JIS20K

Part name	Material	Part name	Material
Flange lagging	SUS316L Stainless steel	Tie bolt	SS400 Carbon steel
Flange	SS400 Carbon steel	Tie plate	SPHC or S400 Carbon steel
External cover	SPHC or SS400 Carbon steel	Ring	SS400 Carbon steel
Bellows	SUS316L Stainless steel	Anchor base	SS400 Carbon steel
Internal sleeve	SUS316L Stainless steel		

Dimensions and weights

(mm, kg)

Type		Single type : JOB40													Double type : JOB41																																
Part	Size	20	25	32	40	50	65	80	100	125	150	200	250	300	20	25	32	40	50	65	80	100	125	150	200	250	300																				
Setting length	L	365				415				440					465				565				680			780			880			930			980			1130									
Max. allowable length	L ₁	375				425				450					475				575				700			800			900			950			1000			1150									
Min. allowable length	L ₂	340				390				415					440				540				630			730			830			880			930			1080									
Max. displacement	δ	expansion (δ e) : 10 contraction (δ c) : 25													expansion (δ e) : 20 (one side : 10) contraction (δ c) : 50 (one side : 25)																																
Anchor base	K	—													60			70			80			100			110			130			150			180			220			280			300		
	J	—													100			120			160			180			200			220			250			300			350								
	H	—													100			120			130			140			150			170			200			220			250			300			350		
	I	—													3.2			4.0			4.5			25																							
	Bolt hole dia	h ₂	—													12			15			19			23			25			27																
	Bolt		—													M10			M12			M16			M20			M22			M24																
D ₀		58		73		98		110		136		162		212		235		292		333		387		61		76		102		140		165		216		236		236		293		334		387			
Weight		3.5	4.5	5.6	6.0	8.9	12	17	22	35	46	60	90	139	6	8	10	11	15	22	30	40	65	80	105	150	250																				

Notice

Expansion joint should be used in extent off allowable length.
 In case it exceed allowable length, please check and modify guide and anchor.