

Bellows type

Type JOB30T, JOB31T Bellows Expansion Joints

Single type



Double type



Features

- Complies with JIS B 2352 standard.
- Bellows made of anti-corrosive material SUS316L (low carbon stainless steel).
- Fluid contact made of stainless steel.
- No leakage because packing is not used.
- Internal casing made of anti-corrosive material SUS316L (low carbon stainless steel).

Specifications

Size	20 – 500
Max. allowable pressure	1.0MPa
Hydrostatic pressure	1.5MPa
Max. allowable temperature	220°C
Fluid	Steam, water, oil and non-corrosive gas
Connection	Flanged JIS10K

Notice

Expansion joint should be used in extent of allowable length.

In case it exceed allowable length, please check and modify guide and anchor.

Construction

Single type

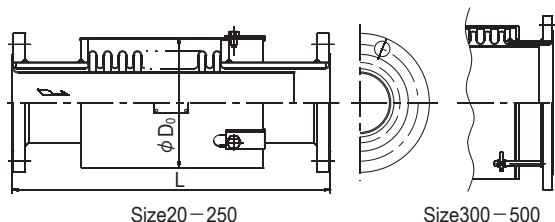

Part name	Material	Part name	Material
Flange lagging	SUS316L Stainless steel	Internal casing	SUS316L Stainless steel
Flange	SS400 Carbon steel	Tie bolt	SS400 Carbon steel
Lagging	SPHC or SS400 Carbon steel	Tie plate	SPHC or SS400 Carbon steel
Bellows	SUS316L Stainless steel	Ring	SS400 Carbon steel

Type JOB30T, JOB31T Bellows Expansion Joints

Double type

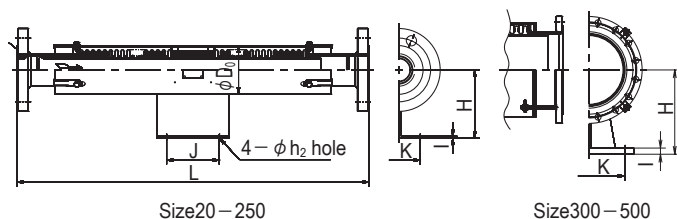

Part name	Material	Part name	Material
Flange lagging	SUS316L Stainless steel	Tie bolt	SS400 Carbon steel
Flange	SS400 Carbon steel	Tie plate	SPHC or SS400 Carbon steel
External cover	SPHC or SS400 Carbon steel	Ring	SS400 Carbon steel
Bellows	SUS316L Stainless steel	Anchor base	SS400 Carbon steel
Internal sleeve	SUS316L Stainless steel		

■ Dimensions and weights

Single type : JOB30T

(mm, kg)

Part	Size	20	25	32	40	50	65	80	100	125	150	200	250	300	350	400	450	500	
Setting length	L	365			415			440			465			490					
Max. allowable length	L ₁	375			425			450			475			500					
Min. allowable length	L ₂	340			390			415			440			465					
Max. displacement	δ	expansion (δ e) : 10 contraction (δ c) : 25																	
D ₀		58	73	98	110	136	162	212	235	292	333	387	422	470	517	567			
Weight		3.5	4.5	5.5	6	7.5	11	12	16	21	27	36	52	111	130	160	186	208	

- Remarks 1. Setting length L is the value to subtract expansion δ e from max. allowable length L₁.
 Expansion joint will be supplied with this length L unless otherwise specified.
 2. Please take off the tie bolt and tie plate after hydraulic test.

Double type : JOB31T

(mm, kg)

Part	Size	20	25	32	40	50	65	80	100	125	150	200	250	300	350	400	450	500							
Setting length	L	680			780			880			930			980			1030			1080					
Max. allowable length	L ₁	700			800			900			950			1000			1050			1100					
Min. allowable length	L ₂	630			730			830			880			930			980			1030					
Max. displacement	δ	expansion (δ e) : 20 (one side : 10) contraction (δ c) : 50 (one side : 25)																							
Anchor base	K	60	70	80	100	110	130	150	180	220	280	300	350	400	450	500									
	J	100			120			160			180			200			250			300					
	H	100	120	130	140	150	170	200	220	250	300	350	450	500	550	600									
	I	3.2			4.0			4.5			25														
	Bolt hole dia	h ₂	12			15			19			23			25			27			33			39	
Bolt		M10			M12			M16			M20			M22			M24			M30			M36		
D ₀		58	73	98	110	136	162	212	235	292	333	387	422	470	517	567									
Weight		5	6	8	8.5	11	14	17	22	35	46	66	96	225	271	325	390	442							

- Remarks 1. Setting length L is the value to subtract expansion δ e from max. allowable length L₁.
 Expansion joint will be supplied with this length L unless otherwise specified.
 2. Please take off the tie bolt and tie plate after hydraulic test.